

± 73,500 SF

FOR LEASE  
**NEW CONSTRUCTION**

SW 44<sup>TH</sup> & MACARTHUR  
OKLAHOMA CITY, OK 73034



COMMERCIAL  
**OKLAHOMA**



# INDUSTRIAL WAREHOUSE FOR LEASE

SW 44<sup>TH</sup> & MACARTHUR BLVD  
OKLAHOMA CITY, OK 73034

Located at the southwest corner of SW 44th and MacArthur is a 73,000 SF + proposed industrial warehouse featuring immediate access to Airport Road linking to Interstate 44 within minutes.

## PROPERTY FEATURES

<b>BUILDING SIZE:</b>	± 73,500 SF
<b>SITE AREA:</b>	± 9.70 Acres
<b>CLEAR HEIGHT:</b>	30' - 32'
<b>COMPLETION DATE:</b>	Est. 2023
<b>COLUMN SPACING:</b>	50' x 50'
<b>DRIVE-INS:</b>	2
<b>DOCKS:</b>	10
<b>ZONING:</b>	I-2
<b>LEASE RATE:</b>	Contact Broker

**CUSHMAN &  
WAKEFIELD**

**COMMERCIAL  
OKLAHOMA**



## SITE PLAN

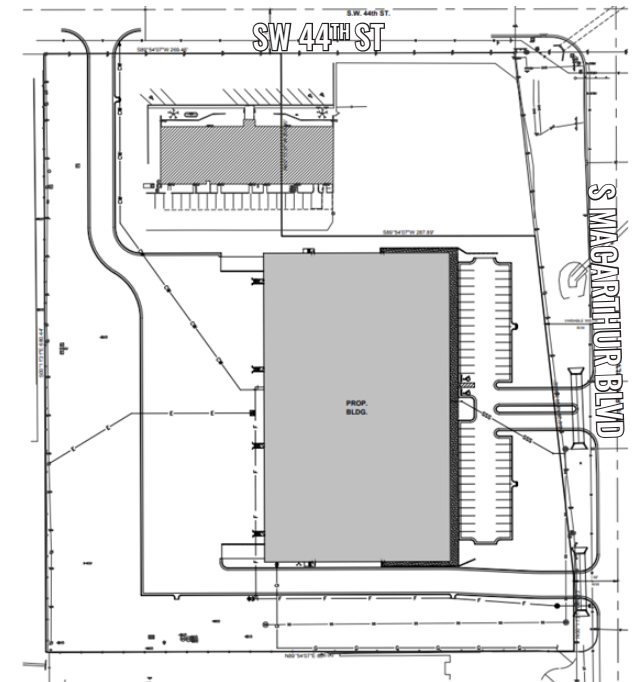

## BROKER CONTACT

ALLAN MEADORS, SIOR  
+1 405 778 9158  
ameadors@commercialoklahoma.com



**OKLAHOMA  
CITY**

204 N Robinson Ave, Suite 2000, Oklahoma City, OK 73102  
+ 1 405 563 5000  
[commercialoklahoma.com](http://commercialoklahoma.com)

©2024 Cushman & Wakefield | Commercial Oklahoma. Independently Owned and Operated / A Member of the Cushman & Wakefield Alliance All rights reserved. The information contained in this communication is strictly confidential. This information has been obtained from sources believed to be reliable but has not been verified. No warranty or representation, express or implied, is made as to the condition of the property (or properties) referenced herein or as to the accuracy or completeness of the information contained herein, and same is submitted subject to errors, omissions, change of price, rental or other conditions, withdrawal without notice, and to any special listing conditions imposed by the property owner(s). Any projections, opinions or estimates are subject to uncertainty and do not signify current or future property performance.